

ZONE	REV	DESCRIPTION	DATE	APPROVED

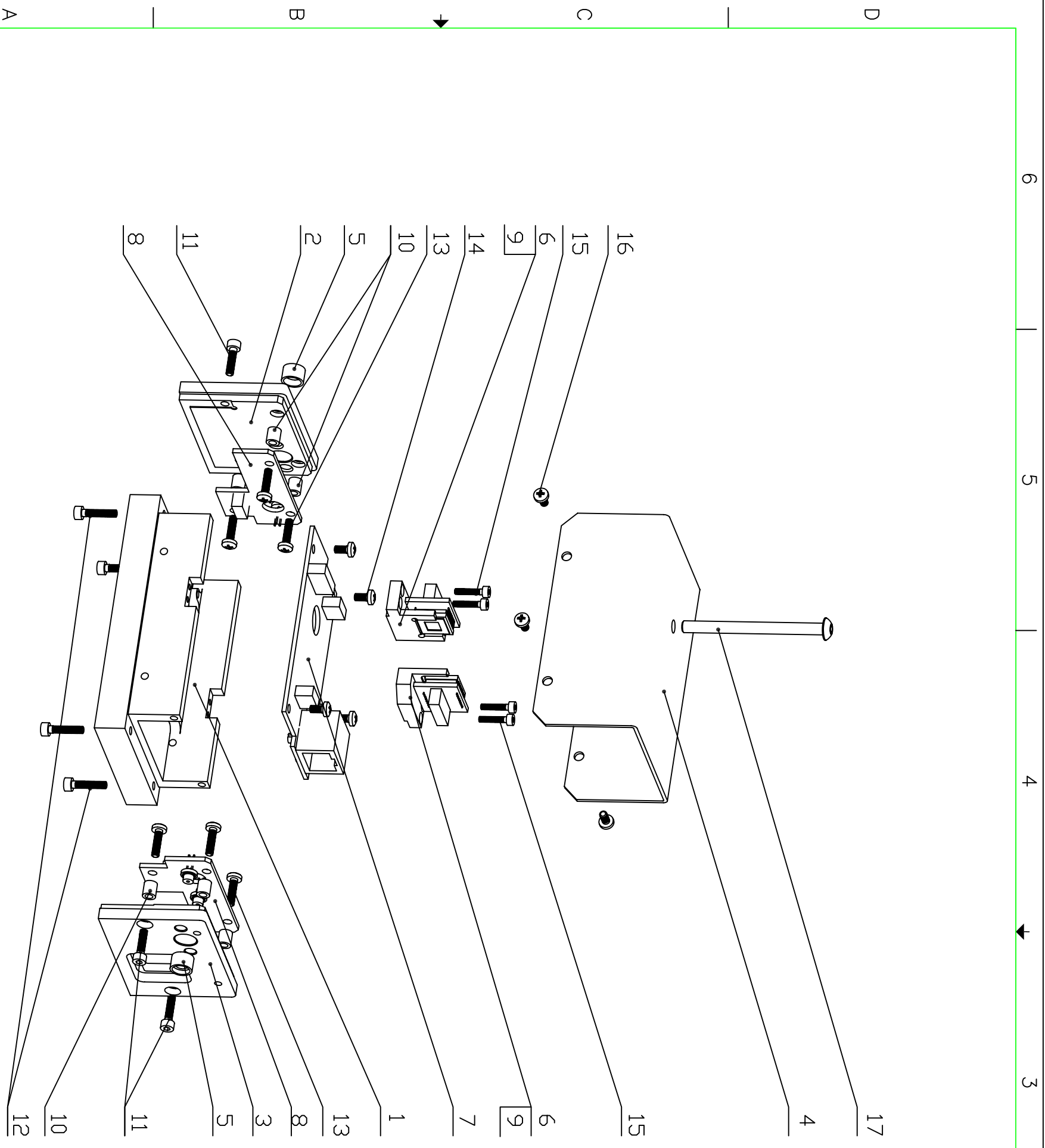

PNQ/REF #	QTY	UOM	PART NAME	MATERIAL	REF. SHEET/DWG.
17	1	EA	SOBREW	316 ST/STEE	
16	4	EA	SOBREW	316 ST/STEE	
15	4	EA	SOBREW	316 ST/STEE	
14	4	EA	SOBREW	316 ST/STEE	
13	6	EA	SOBREW	316 ST/STEE	
12	4	EA	SOBREW	316 ST/STEE	
11	4	EA	SOBREW	316 ST/STEE	
10	6	EA	STANDOFF	ALUMINUM	
9	2	EA	PCBOUT BOARD		A207801J
8	2	EA	PCBOUT BOARD		A207401F
7	1	EA	PCBOUT BOARD		A208601B
6	2	EA	COB FRAME	ALUMINUM	
5	2	EA	LENS HOLDER	BRASS	
4	1	EA	COVER	ALUMINUM	500120003
3	1	EA	FLANGE-R	ALUMINUM	500120101
2	1	EA	FLANGE-F	ALUMINUM	500120201
1	1	EA	BASE	ALUMINUM	500120001

PARTS LIST		PERMISSIBLE VARIATION IN MM DIMENSIONS WITHOUT TOLERANCES	
DIMEN	< 3	3-6	6-10
TOLER	±0.05	±0.06	±0.075
DIMEN	120-180	180-300	300-500
TOLER	±0.200	±0.250	±0.315
ANGLE	±1°	±30'	±20'

DRAWING INFORMATION		DRAWING INFORMATION	
NAME	DATE	NAME	DATE
ANDREY	03/09/18	ANDREY	03/09/18
CHECKED		CHECKED	
APPROVED		APPROVED	
HIGH ENERGY PHYSICS LABORATORY		HIGH ENERGY PHYSICS LABORATORY	
TITLE: NSW ALIGNMENT D-BCAM, BLUE ASSEMBLY		TITLE: NSW ALIGNMENT D-BCAM, BLUE ASSEMBLY	
DRAWING NUMBER: 500.12.00.00		DRAWING NUMBER: 500.12.00.00	
SHEET: 1 OF 1		SHEET: 1 OF 1	
REVISION: A		REVISION: A	

6 5 4 3 2 1

A B C D

1 2 3 4 5 6

A B C D